

# BUILT-IN BURNER WITHOUT LIP™

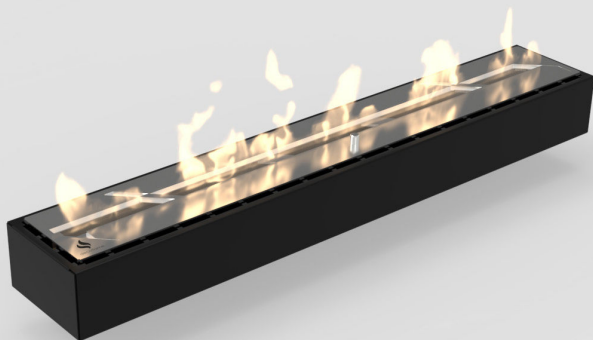

The decoflame® Built-in Manual Burner with Lip™ is part of the built-in models.

Its simple design makes it versatile and adaptable for a large variety of fireplace applications. The burner's length can be 400 - 500 - 600 - 700 - 800 - 900mm.

## FEATURES

- DecoFlame® brushed stainless steel manual burner
- Safety chamber
- Adjustable flame height
- No chimney required
- Safety chamber
- Shutter tool
- 3M Sponge
- Optional hardened, diamond clear glass

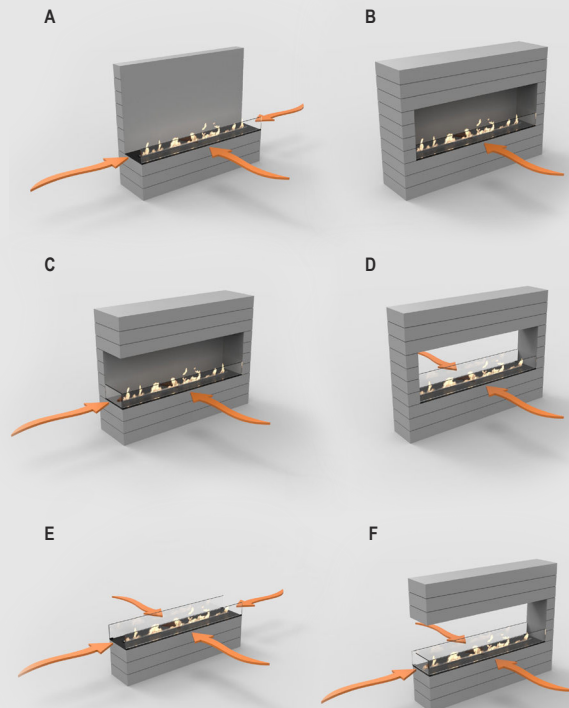

DecoFlame highly recommends ordering and installing one or several glass screens in order to protect the flame from draught, while keeping it vivid.

### The glass screen is available on request.

It can be mounted onto the surface in which the bio fireplace is installed. Built-in burner without lip **can not** be ordered with mounted glass on the burner.

**Model A-B** One low glass.

**Model C, E, F** Low glass. We recommend it as illustrated for the best result regarding design and operation.

**Model D** Two low glass or one full glass and one low glass.

## TECHNICAL INFORMATION

	400mm	500mm	600mm	700mm	800mm	900mm
Capacity / Liter	1.9	2.4	2.9	3.4½	3.9	4.4
Fuel consumption l/h	0.27	0.34	0.41	0.48	0.56	0.62
Burning time / Hours	> 7 hours	> 7 hours	> 7 hours	> 7 hours	> 7 hours	> 7 hours
Heat output max: kWh	2.6 - 1.6	3.4 - 2.0	4.0 - 2.4	4.8 - 2.7	5.4 - 3.2	6.1 - 3.6
Net weight: kg	5.1	6.3	7.5	8.5	9.6	10.8
Minimum room size: m³	32	40	48	56	64	72

## BIOETHANOL

For use and information about bioethanol, please visit our website [decoflame.com](http://decoflame.com).

(Please be aware that bioethanol is essential to a proper use and guarantee of your product).

## DIMENSIONS:

### BUILT-IN BURNER

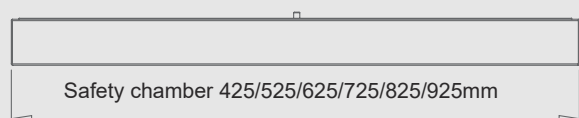
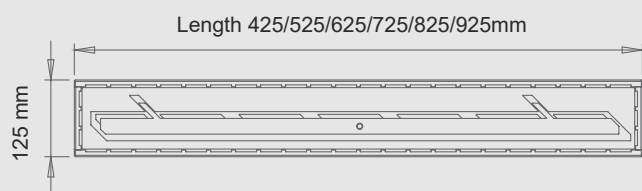

### WALL CUT-OUT

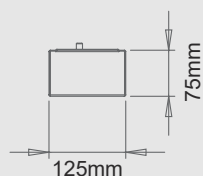
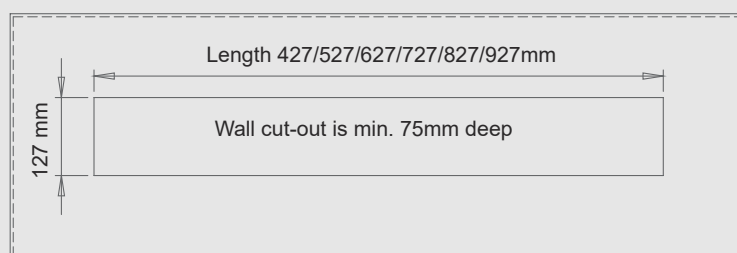

It is imperative to follow the indications in the User manual, concerning the installation of decorative or electronic items above the fireplace.

