

# HYBRID MIST FIREPLACE™

## 720mm - 920mm - 1120mm



3 sizes

The Hybrid Mist Fireplace has been developed with a technology that atomizes the water vapor. The mist can then be controlled electronically and combined with special built-in LED lights in different colors which give the illusion of real flames.

For those who are not much for open fire in the home when there are small children or pets around, this is a great alternative.

This fireplace comes in three standard sizes.

### FEATURES

- Hybrid Mist Technology
- Water Level Indicator / Flame Level Indicator
- Remote control
- Bluetooth / App
- 6 flame levels

### TOP FINISH

- Standard: Black powder coated top-plate

### GLASS

- Optional: Glass screen.

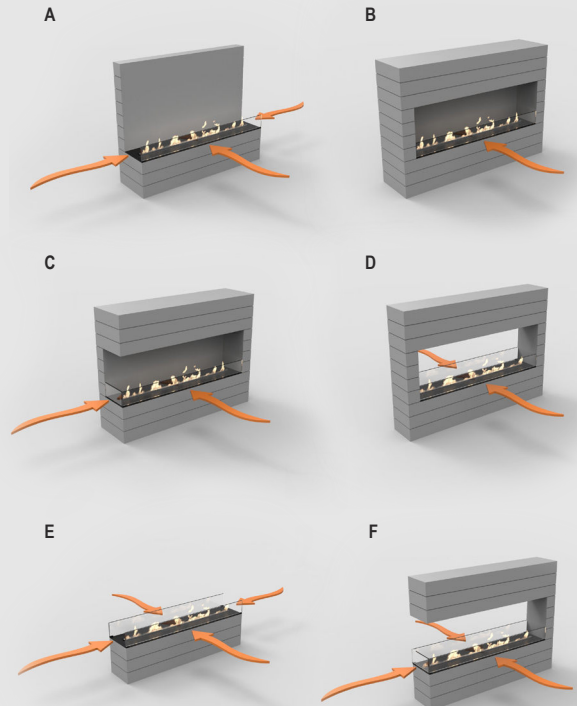

Decoflame recommends installing one or more glass shields in order to protect the mist from draught, while keeping it vivid.

It is possible to order more glasses for version B-F.

In version C and F, it is only possible to order the small end glass - if the topplate is minimum 300mm in depth.

### TECHNICAL INFORMATION

	720mm	920mm	1120mm
Size	720x217x232	920x217x232	1120x217x232
Flametray size	500mm	700mm	900mm
Capacity	6L	8L	10L
Fuel consumption	125 ml/h	150 ml/h	175 ml/h
Burning time	> 48 h	> 53 h	> 57 h
Net weight	14,5 kg	18,5 kg	23,5 kg

Power supply: 220V - 240V, 50 Hz